

1. PRODUCT SUMMARY

The Primex Cat5e 90° and 180° UTP keystone jacks fit in standard wall plates and provide easy high-speed data access.

Available in either 90 and 180 degree configurations, these UTP keystones are UL-Listed and offer dual 568A/B wiring labels for easy installation.

Pairing them with Primex wall plates in 1-4 port configurations offers versatile installation options.

2. PRODUCT DIMENSIONS

SIZE: Fits standard wall plates

3. FEATURES & BENEFITS

- Available in 90° or 180° configurations.
- Dual 568A/B wiring label.
- 110 Universal IDC.
- Includes dust cover for protection of socket from dust.
- Pairs with Primex wall plates in 1-4 port configurations.
- UL/CUL listed
- Applicable specifications:
ANSI/TIA/EIA-568-C.2-1, ISO/IEC 11801 2nd edition: 2002, EN50173-1: 2002, FCC Part 68

4. CONFIGURATIONS

Part #	Description
125-0949-WT	Cat5e, 110 IDC, 90° HD
125-0948-WT	Cat5e, 110 IDC, 180° HD

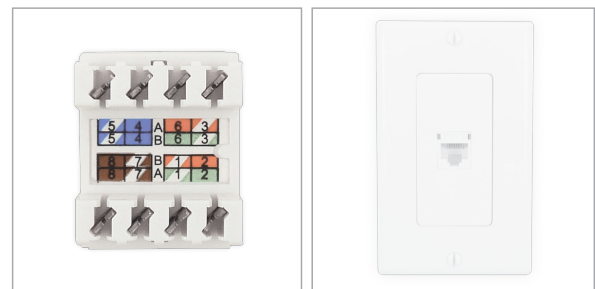

Cat5e 180° Keystone

Pairs with standard keystones.

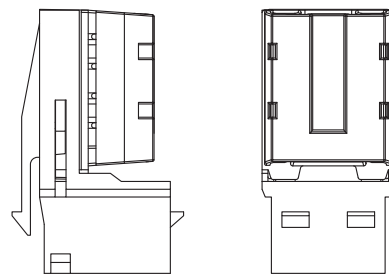
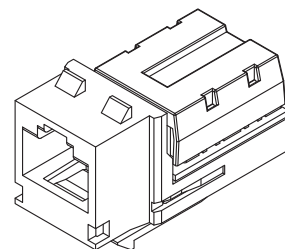

Cat5e 90° Keystone shown

FOR MORE INFORMATION CONTACT:

20160 92A Avenue Langley BC V1M 3A4 Canada
 1.604.881.7875 1.877.881.7875 primexfits.com